

RANCH - ACREAGE
 103 ACRES WITH HOME
 GREAT FOR DEVELOPMENT
 JUST OUT OF THE CITY
 VIEWS, WILDLIFE, TASTIC, FENCED
 LARGE COUNTRY HOME
 ORIGINAL LAMPASAS GOLF COURSE
 FANTASTIC VIEWS, TREES
 RURAL WATER

GREAT PROPERTY!

www.JamesHargroveRealEstate.Com

Connie Cummings, Agent
 205 S. Key, Lampasas, TX 76550
 Office 512.556.8286
 Cell 512.734.1988
www.JamesHargroveRealEstate.Com



103 acres just past the city limits at 1552 FM 580 West. A once in a lifetime property. This property has exceptional development potential. It is a highly desired area which is across the street from Fawn Acres Subdivision and near the City of Lampasas new recreation park. Rural Water available. There is wildlife, large oaks, views, 2 stock tanks, a well, pens and wonderful views. This beautiful property was once the original Lampasas golf course and country club. The lovely country home on this property was the original club house. It has been updated and sits hidden among large oaks that are hundreds of years old. The den boasts the original stone fireplace. The floors are all wood, much of which is original to the home. There is new wiring, central heat and air, build-in shelving, new windows and much more. **Call today!**

Please call for further details.

PRICE: Call 512.556.8286

Connie Cummings



Please call for further details. Connie Cummings, Agent
 Office 512.556.8286 Cell 512.734.1988



Please call for further details. Connie Cummings, Agent
Office 512.556.8286 Cell 512.734.1988
Page 2 of 6



Please call for further details. **Connie Cummings, Agent**
Office 512.556.8286 Cell 512.734.1988
Page 3 of 6



Please call for further details. **Connie Cummings, Agent**
Office 512.556.8286 Cell 512.734.1988
Page 4 of 6



Please call for further details. **Connie Cummings, Agent**
Office 512.556.8286 Cell 512.734.1988
Page 5 of 6

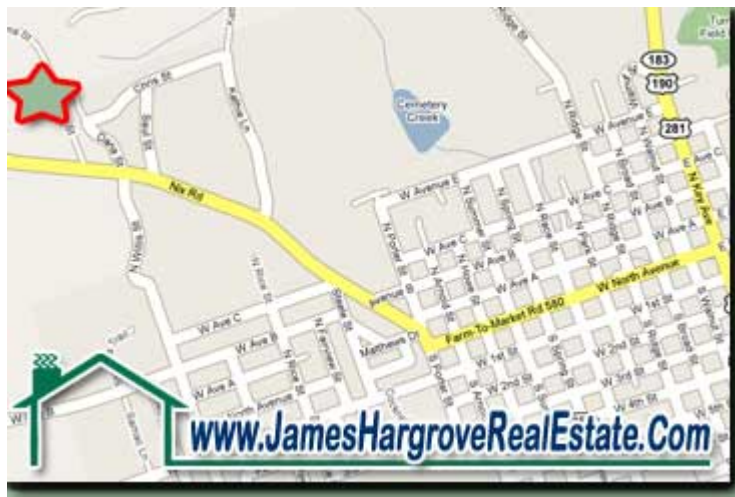

This is a really great property so don't wait, call Connie Cummings today!
512.556.8286
After Hours: 512.734.1988

Please call for further details. Connie Cummings, Agent
Office 512.556.8286 Cell 512.734.1988
Page 6 of 6